

Franklyn James



Hera Court, Homer Drive

, London, E14 3UJ

Offers In Excess Of £380,000

Share of freehold. Approx. 709 SQFT. Offered to the market with no onward chain and in superb condition, is this one double bedroom apartment in the sought-after Cyclops Wharf development! The accommodation comprises main entrance with lift, entrance hall, a large reception room and separate kitchen. There is one double bedroom and the bathroom has been fitted with a contemporary three-piece suite. The property is in one of E14's most sought-after developments and benefits from gated, covered parking. Cyclops Wharf is ideally located within close proximity to Mudchute DLR Station which provides superb transport links into the City and Canary Wharf. Residents can enjoy the on-site leisure complex which includes a swimming pool, sauna, steam room and gymnasium. There is also a 24 hour on-site concierge, so you need never miss a delivery again! Additional features to include private covered parking and situated moments from Canary Wharf. Call now to arrange your viewing.

- One double bedroom
- Allocated parking
- No onward chain
- Residents Gym
- Spa facilities
- Swimming Pool
- Share of Freehold
- Gated development
- Approx. 709 SQFT

Viewing

Please contact our Westferry Sales Office on 02070056080 if you wish to arrange a viewing appointment for this property or require further information.



Floor Plan

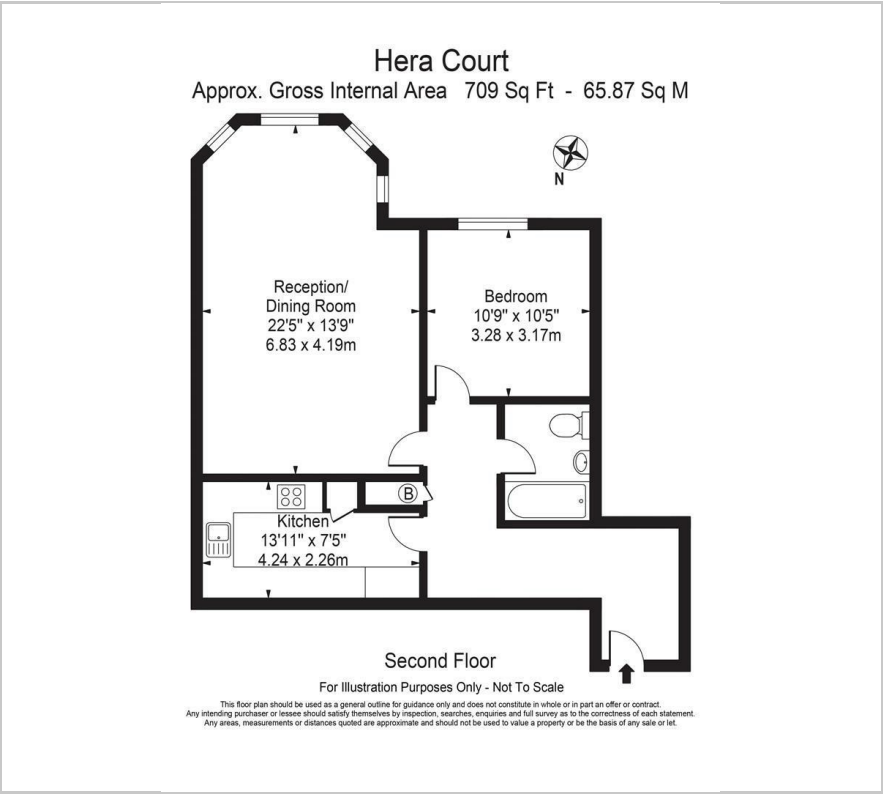

Area Map



Energy Efficiency Graph

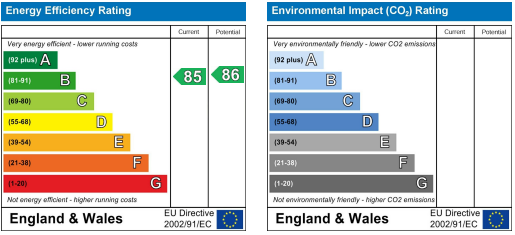

These particulars, whilst believed to be accurate are set out as a general outline only for guidance and do not constitute any part of an offer or contract. Intending purchasers should not rely on them as statements of representation of fact, but must satisfy themselves by inspection or otherwise as to their accuracy. No person in this firm's employment has the authority to make or give any representation or warranty in respect of the property.